

Serie Cont-EX Membranpumpen

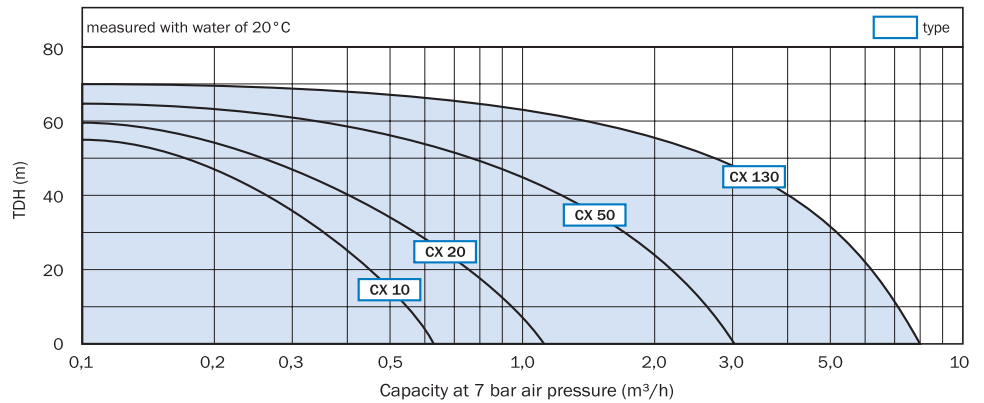

Technische Daten

| Modell | | CX 10 | CX 20 | CX 50 | CX 130 |
|---------------------------|--|-------|-------|-------|--------|
| Anschlüsse (NPT) | | 3/8" | 1/2" | 3/4" | 1 1/4" |
| Luftanschluss (R) | | 1/4" | 1/4" | 1/4" | 1/4" |
| Gewicht (kg) | | 1,2 | 2 | 4,5 | 10 |
| Max. particle size (mm) | | 1,5 | 2 | 3 | 4 |
| Suction height (dry, mwc) | | | | | |
| Zylinderventile | | 1,5 | 2 | 3 | 4 |
| EPDM Kugelventile | | 0,5 | 0,5 | 1 | 2 |
| PTFE Kugelventile | | 0,5 | 0,5 | 1,5 | 2,5 |
| Edelstahl Kugelventile | | 1 | 1 | 1,5 | 3 |
| Saughöhe geflutet (mWS) | | 8 | 8 | 9 | 9 |
| Viskosität (cP) (max) | | 3000 | 6000 | 10000 | 15000 |
| Temperatur (°C) (max.) | | 70 | 70 | 70 | 70 |

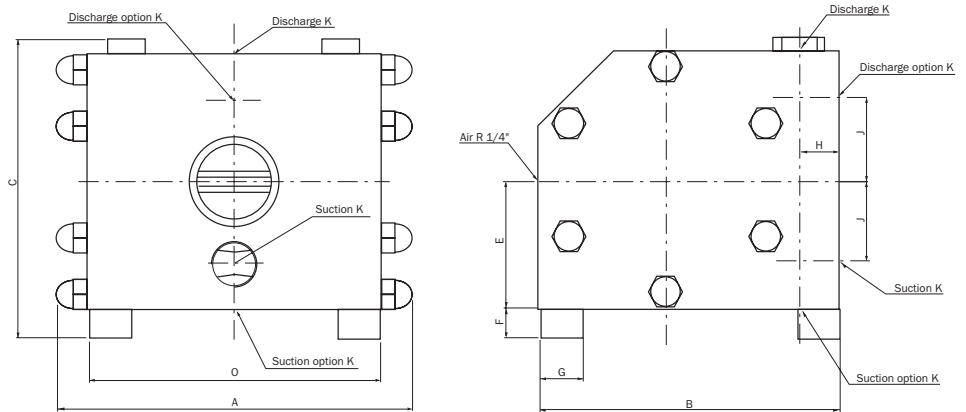

Maße in mm

| Modell | A | B | C | D | E | F | G | H | J | K (NPT) |
|--------|-----|-----|-----|-----|-----|----|----|----|----|---------|
| CX 10 | 137 | 86 | 96 | 113 | 41 | 8 | 15 | 15 | 27 | 3/8" |
| CX 20 | 155 | 124 | 128 | 125 | 53 | 17 | 25 | 19 | 34 | 1/2" |
| CX 50 | 206 | 175 | 173 | 170 | 75 | 17 | 25 | 22 | 48 | 3/4" |
| CX 130 | 269 | 240 | 225 | 225 | 100 | 17 | 25 | 33 | 63 | 1 1/4" |

Werkstoffe Serie Cont-EX CX

| | |
|-------------|----------------------|
| • Gehäuse | PE (UHMW) conductive |
| • Membranen | PTFE-TFM, EPDM |
| • Kugeln | EPDM, PTFE, SS 316 |
| • Ventile | PE |